

Do you need
ULTRA HIGH SECURITY
AND BIG BANDWIDTH?
THINK TECH CENTER

Through our
Partnership with
MetNet, The Tech
Center can provide
You with 1 GB,
10 GB or more —all
in a Generator
Supported, Ultra
High Security
Building!

Fast, inexpensive, secure
and available.
Call 412.471.6868
dbishoff@evbco.com

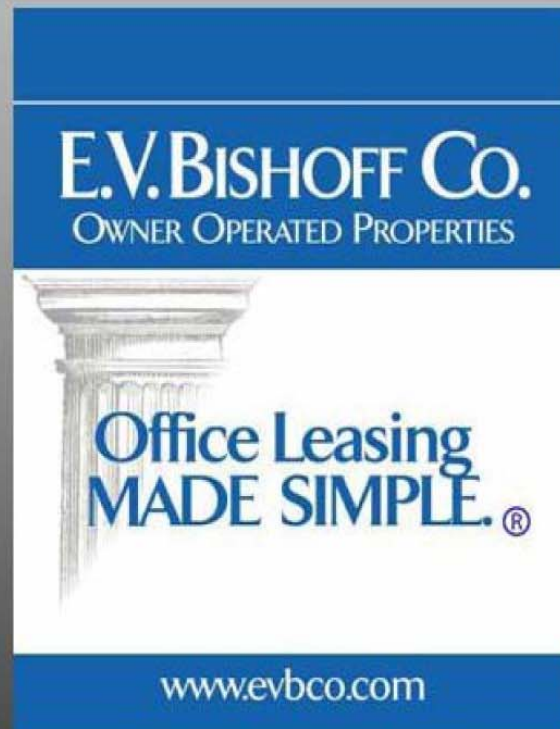

E.V. BISHOFF CO.
OWNER OPERATED PROPERTIES

Office Leasing
MADE SIMPLE.®

www.evbco.com



Met-Net
SCALABLE BANDWIDTH

TECH CENTER

DOWNTOWN PITTSBURGH

THE PITTSBURGH INFORMATION TECHNOLOGY CENTER OFFERS UNLIMITED BANDWIDTH AND IS HANDS DOWN THE MOST SECURE AND LOGICAL LOCATION IN ALL OF PENNSYLVANIA.

- REDUNDANCY OF FIBER CARRIERS
- REDUNDANCY OF TELECOM PROVIDERS
- REDUNDANCY OF ELECTRICAL TRANSFORMERS
- FULL GENERATOR BACK UP
- ON SITE FOOD AND BEVERAGE
- ON SITE RECREATION ROOM
- PUBLIC TRANSPORTATION
- OPERATING 24/7
- DAY CARE CENTERS NEARBY

Specifications and Features

Specifications

- **Backup Generator**
Generator capacity: 1450 KVA
Fuel tank capacity: 16,000 thousand gallons
Building critical functions tied into system
- **Dual Electric Transformers - Diverse Fiber Entries**
- **Telecommunications**
- **Consolidated Communications is one of the PITC's partners providing voice, data and all the vertical services. . They have a floor in the facility and maintain a telecom switching facility in the building. This partnership allows us to offer customers a level of service that is not available in ordinary office buildings.**
- **Sonet Ring: All seven high rises owned by the E.V. Bishoff Company are supported with a sonet ring, increasing data and dial tone security and flexibility.**
- **Broadband Options**
DQE's 200-mile dark fiber network hub
Consolidated Communications
Met-Net
XO Sprint
Expedient
Verizon Level 3

Features

Meet Me Room - Locally owned and managed

- **Loading Area – The dock is accessible from 4th Ave.**
- **In-building Restaurant, game room and vending Area**
- **Conference Rooms – 24/7/365 Operations**
- **Adjacent Parking**
- **ATM Machines – Dollar Bank, National City, Parkvale and Three Rivers**
- **Machines located within one half block of the PITC.**
- **Day Care Centers Nearby**
- **Public Transportation from all parts of the City.**
- **Building Security**
 - **Key FOB access – add and delete employees as needed.**
 - **Monitored CCTV video surveillance**
 - **24 hr 1-800 maintenance emergency hotline**
- **Fire Protection**
 - **Building is protected by an electronic smoke system that is tied directly to the fire department with available raised floors supported by a dry-pipe, pre-action, double interlock fire suppression system.**
- **In Building Data Center provided by Sierra Data Centers**
- **Unlimited Bandwidth with no cost to build**

As a Client in the Pittsburgh Information Technology Center Enjoy Access to:

DQE's 200-mile dark fiber network hub



**Consolidated Communications
Level 3
Expedient
Verizon
Met-Net**

**Sprint
XO**

Local Management Guarantees:

- Simple Contract
- Simple Cost Structure
- Immediate Response Time
- Neutral Environment
- Access 24/7

Contact:

**The Pittsburgh Information Technology Center
322 Fourth Avenue
Between PPG and One Oxford Centre
Downtown Pittsburgh
412-471-6868**

E.V. BISHOFF CO.
OWNER OPERATED PROPERTIES

Office Leasing
MADE SIMPLE.

www.evbco.com

Typical Floor Will Accommodate Up To 50- 80 People depending on layout

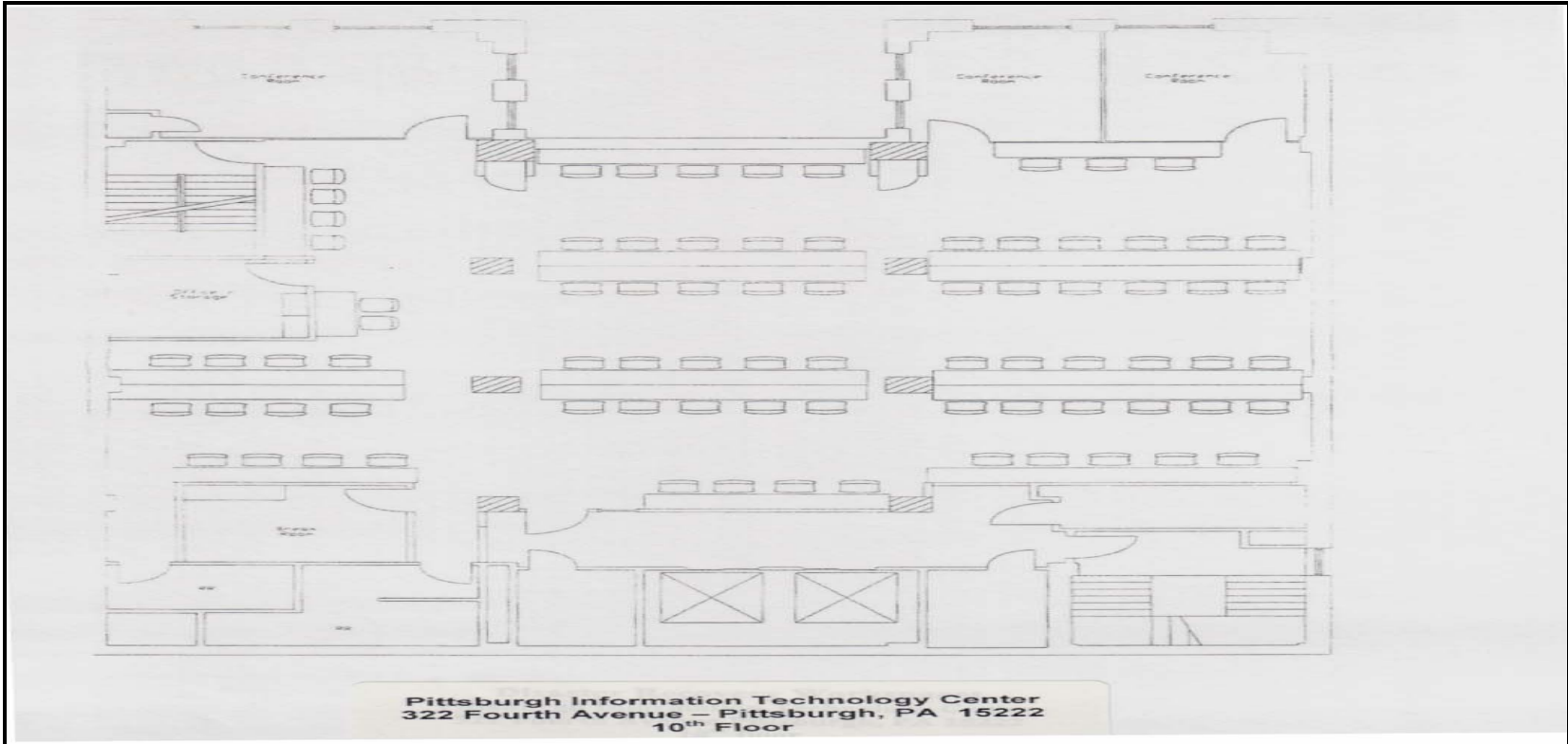

Testing of Center

E.V. BISHOFF CO.
OWNER OPERATED PROPERTIES

Office Leasing
MADE SIMPLE.®

www.evbc.com

Our commitment to excellence is illustrated by our stringent testing of all mission critical equipment in the Center.

Testing includes:

Generator:

- **Monthly Inspections by Beckwith Power Systems**

Sonet:

- **24 hr per day ping tested**

Fuel Tanks & Pumps:

- **Regular preventative maintenance inspections performed by our in-house technicians**

Fire Systems:

- **Inspected annually by City fire marshal and our fire suppression contractor**

Elevators:

- **Elevator maintenance contract. Annual State inspections.**

Electric Provided to Center by DQE:

- **Power fed from two separate transformers**

Electrical Testing by Siemens

Reporting of Test Results:

All relevant test results from building critical systems are reported to the clients who depend on our Center's performance